

# INSTRUCTION MANUAL INSERT FOR RUGER® CUSTOM SHOP 10/22® RIFLE



**NOTE:** The RUGER® CUSTOM SHOP 10/22® RIFLE has the same basic operational characteristics as all other RUGER® 10/22® rifles. This insert provides information regarding specific features of the RUGER® CUSTOM SHOP 10/22® RIFLE. Please refer to the full instruction manual for additional information and important warnings.

– RUGGED, RELIABLE FIREARMS® –



**READ THE INSTRUCTIONS AND  
WARNINGS IN THIS MANUAL AND THE  
FULL INSTRUCTION MANUAL CAREFULLY  
BEFORE USING THIS FIREARM**

© 2020 Sturm, Ruger & Co., Inc.

This manual may not be reproduced in whole or in part without the express written permission of Sturm, Ruger & Co., Inc.

**For Service on This Model Please Call:  
(336) 949-5200**

THIS INSTRUCTION MANUAL SHOULD ALWAYS ACCOMPANY THIS FIREARM AND BE  
TRANSFERRED WITH IT UPON CHANGE OF OWNERSHIP, OR WHEN THE FIREARM IS LOANED  
OR PRESENTED TO ANOTHER PERSON

RUGER.COM

CS 10/22 6/2020 R1

# TABLE OF CONTENTS

|                                  | <b>Page</b> |
|----------------------------------|-------------|
| General Information .....        | 3           |
| Nomenclature .....               | 3           |
| The Bolt Lock .....              | 4           |
| Ammunition Warning .....         | 5           |
| Special Safety Note .....        | 5           |
| Adjusting the Cheek Piece .....  | 6           |
| Disassembly .....                | 8           |
| Reassembly .....                 | 14          |
| Parts List & Exploded View ..... | 19          |

“RUGER” is a registered U.S. trademark.

# GENERAL INFORMATION AND MECHANICAL CHARACTERISTICS

The RUGER® CUSTOM SHOP 10/22® RIFLE features an adjustable comb; textured laminate stock; threaded, fluted barrel with “CUSTOM SHOP” enhanced chamber; “CUSTOM SHOP” receiver with integral Picatinny rail; and “CUSTOM SHOP” bolt and bolt handle. This model uses the same ten-shot rotary magazines as the 10/22® Carbine models and is chambered for the 22 Long Rifle cartridge.

## NOMENCLATURE

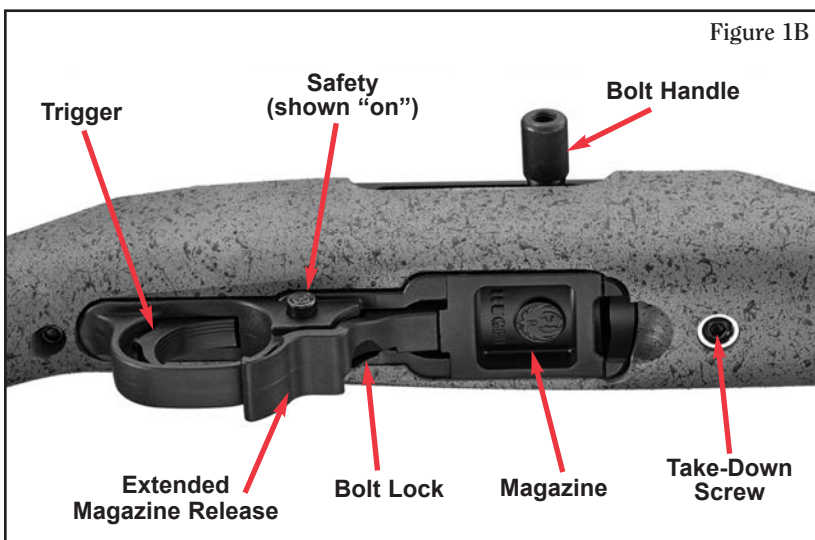
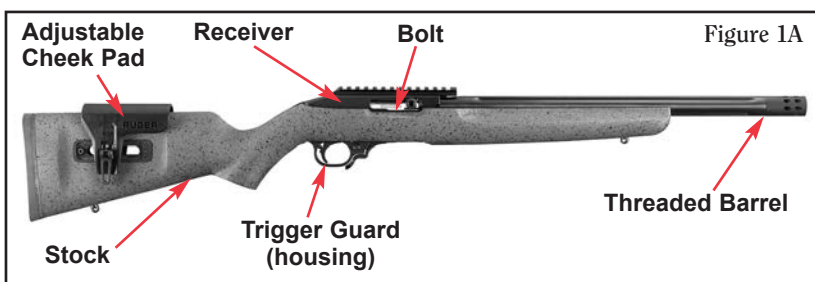

These illustrations identify the frequently used operating components of the rifle. Note that the safety is protruding fully from the right side of the trigger guard and is therefore in its “on” (safe) position.

# THE BOLT LOCK

The bolt lock is located in the forward section of the trigger guard (see Figure 1B, p. 3). The bolt lock is the manually operated means of retaining the bolt in the rearward (open) position. When the bolt is locked open, the rifle is in an inoperative safe condition for inspection of the chamber, cleaning, etc.

## **To lock the bolt open:**

Remove the magazine (refer to page 21, steps 1 - 3, of the enclosed 10/22® instruction manual). Retract the bolt handle to its extreme rearward position and, while holding it there, push the bolt lock up. (See Figure 2.) Release the bolt handle and it will move forward a fraction of an inch, allowing the bolt to engage the bolt lock and remain locked in the open position.

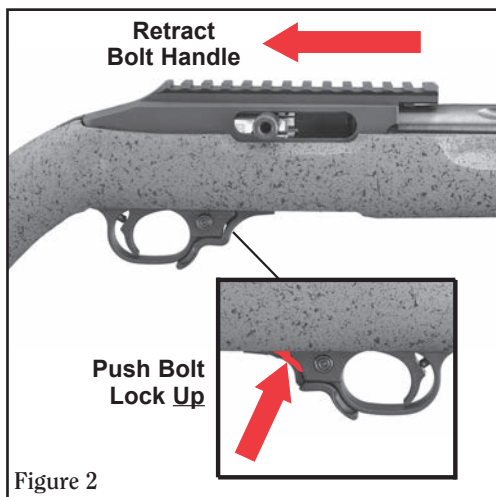

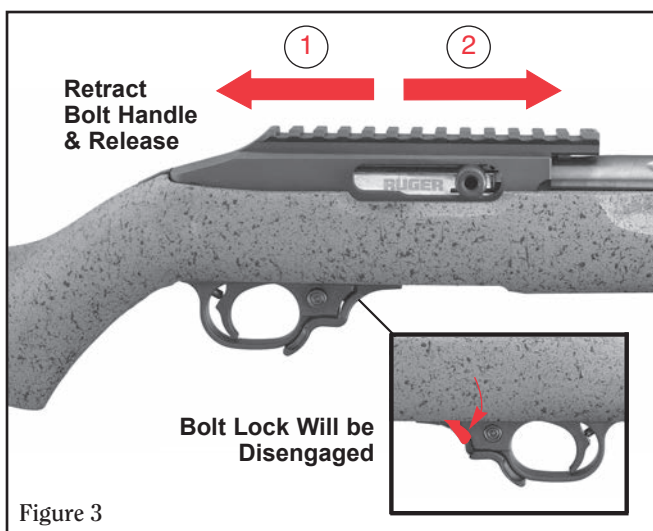

**To release the bolt:** Retract the bolt handle to its extreme rearward position and then release it. The bolt will move fully forward. (See Figure 3.)

**NOTE:** Retracting the bolt will disengage the bolt lock.



## AMMUNITION WARNING

|   |   |
|---|---|
|  <b>WARNING – “STINGER” AMMUNITION</b> |   |
| <br><b>22 LR</b> <b>22 "Stinger"</b>   | <p>“Stinger” cartridges have a longer case than 22 LR cartridges loaded to U.S. Industry specifications. They can stick in the tighter chambers of target rifles, including the Ruger® Custom Shop 10/22® rifle, which can result in a hazardous ruptured case and release of hot powder gasses and brass when fired.</p> |
| <b>DO NOT USE<br/>“STINGER” AMMO IN<br/>CUSTOM SHOP 10/22® RIFLES</b>   |   |

## SPECIAL SAFETY NOTE

The special model you have selected is specifically designed for rapid fire precision target shooting. As such, it demands that you take extra safety precautions.

The trigger of the RUGER® CUSTOM SHOP 10/22® RIFLE has a lighter, target trigger pull than standard 10/22® rifles and carbines for more precise placement of shots. You should practice “dry-firing” an empty rifle (with it pointing in a safe direction) to learn the “feel” of the trigger before ever loading it with ammunition.

|   |   |
|---|---|
|  <b>WARNING – TARGET TRIGGER</b> |   |
|                                  | <p>Custom Shop 10/22® Rifles have a target trigger that has been carefully set at the factory to a minimum safe weight of pull for precision target shooting. Do not alter any factory setting! You can create an unsafe condition and the rifle may fire unexpectedly.</p> |
|                                  | <p>You should be especially careful to <b>keep the safety on at all times except when actually firing</b>. Also, in order to minimize the possibility of accidental discharge, <b>keep your finger off the trigger</b> unless you are squeezing it to fire.</p>             |
| <b>DO NOT TAMPER WITH TRIGGER -<br/>KEEP SAFETY ON UNLESS FIRING</b>  |   |

## ADJUSTING THE CHEEK PIECE

1. The cheek piece can be adjusted forward and rearward and up and down. Raise the cam lever on the cheek piece to change its position forward or rearward. (See Figure 4.)

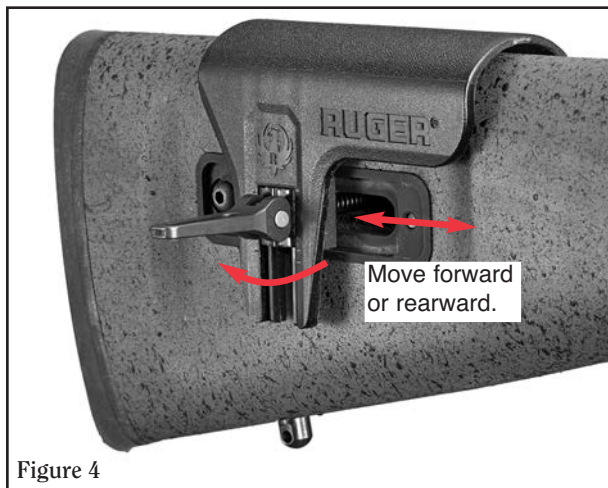

2. At the same time, move the cheek piece up or down to the desired height. (See Figure 5.)

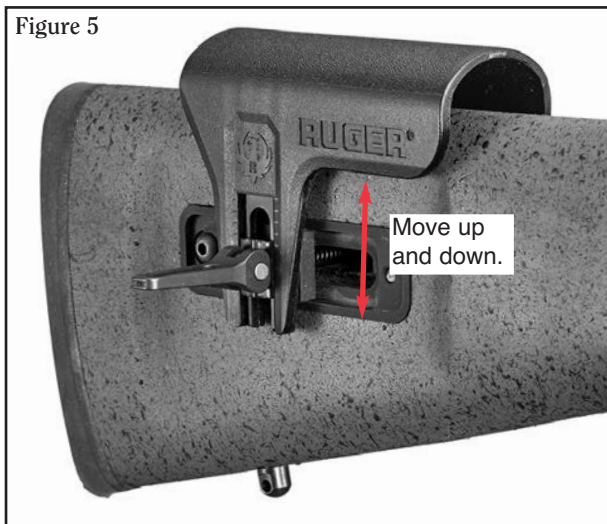

3. Once the desired cheek piece position is achieved, lock down the cam lever. (See Figure 6.)

The cam lever can lock either upward or downward.

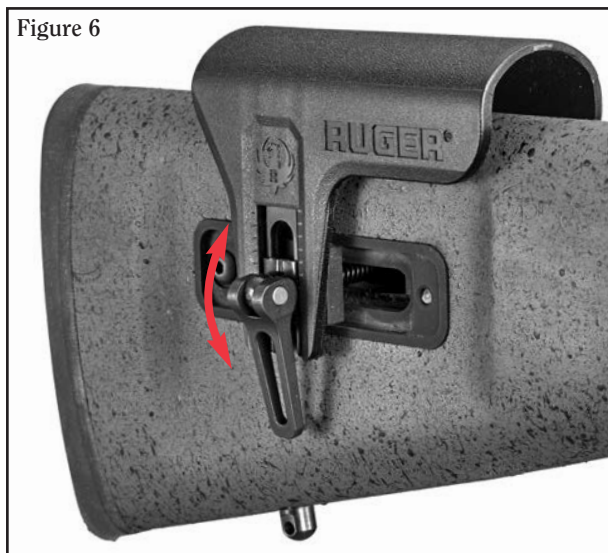

4. The cheek piece can be reversed by removing the cheek piece, rotating it 180°, and reinstalling it. (See Figure 7.)

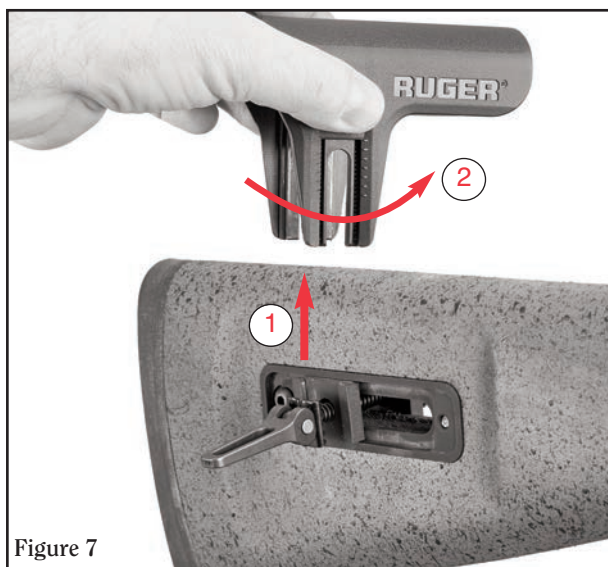

# DISASSEMBLY

## BE SURE RIFLE IS UNLOADED!

An on-line video demonstrating the disassembly and reassembly of the 10/22® rifles can be viewed by going to **Ruger.com/TechTips**.

1. With the rifle pointing in a safe direction, remove the magazine, open the bolt and visually make certain there is not a cartridge in the chamber. Allow the bolt to close. The hammer should be cocked.
2. Use a 5/32" Allen wrench to remove the rear takedown screw. Loosen, but do not remove, the front takedown screw. (See Figure 8.)

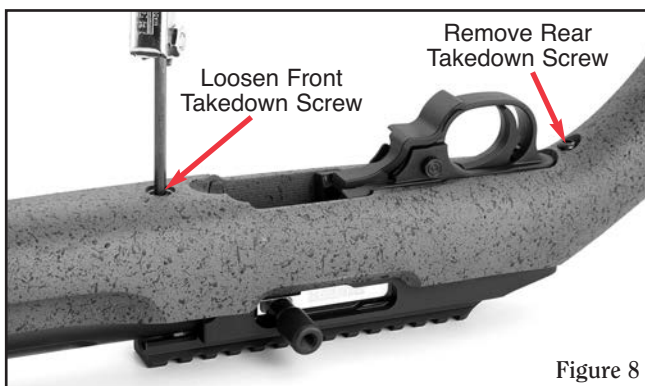

3. Position the safety so an equal amount of the button is exposed on each side. If the safety is not in the middle when the barrel-receiver assembly is lifted out of the stock, the stock will be damaged. (See Figure 9.)

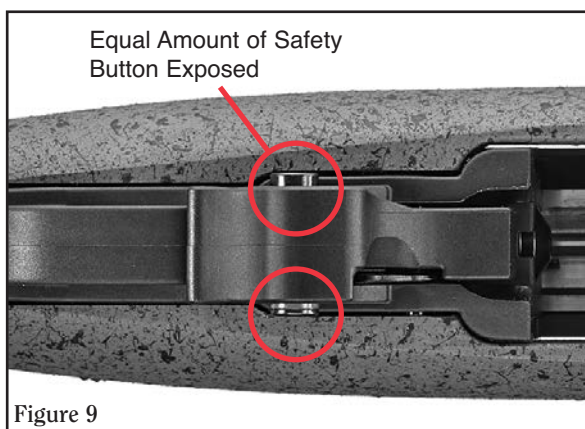



- Figure 10A
- 
- Figure 10A shows a close-up of the upper portion of the device. It features a textured, cylindrical body with a mounting bracket. A red arrow points upwards, indicating the direction of movement or adjustment.

Be careful pins  
do not fall out.

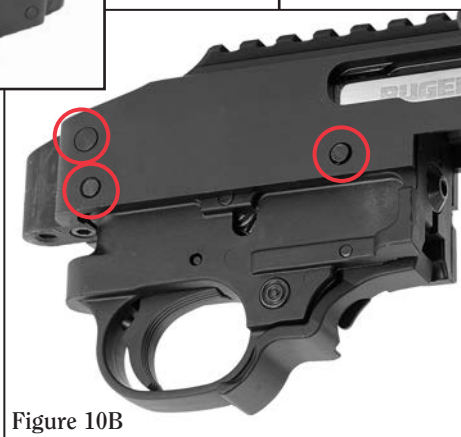
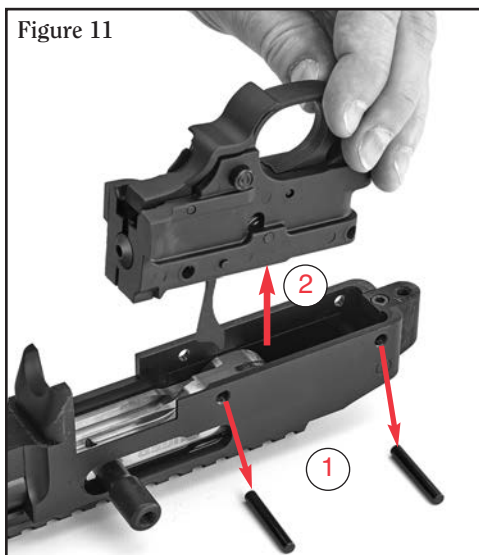

Figure 10B



5. Place the safety in the “ON” position. Remove the trigger housing by simply drifting out the two receiver cross pins and lifting the trigger housing up and out of the receiver. (See Figure 11.) It is recommended that the components of the trigger housing assembly not be disassembled from the trigger guard.

**NOTE: This is the extent of disassembly required for routine inspection, cleaning and lubrication.**

**NOTE:** The rear bedding block must be removed before installing the CUSTOM SHOP 10/22® RIFLE's barrel/receiver assembly into a standard 10/22® stock.

**To Remove the Rear Bedding Block:**

1. Loosen and remove the rear bedding block screw. (See Figure 12A.)
2. Remove the rear bedding block insert from the slot in the receiver. (See Figure 12B.)

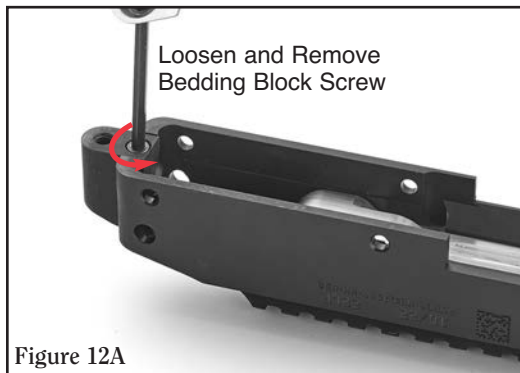

**To Reassemble the Rear Bedding Block:**

1. Place the rear bedding block insert into the slot in the receiver. (See Figure 13.)
2. Next, insert the bedding block insert screw through the hole in the bedding block and into the hole in the receiver. (See Figure 13.) Hand tighten the screw to secure the bedding block insert to the receiver.

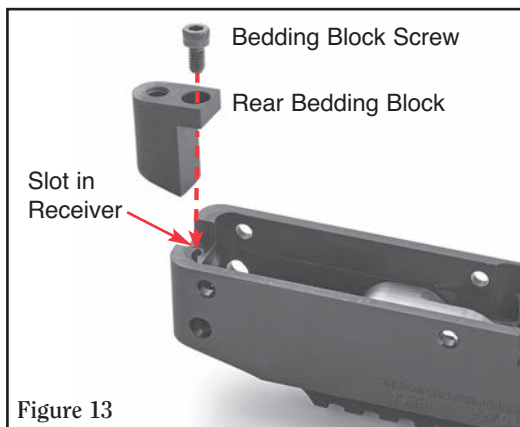

### To Remove the Barrel:

1. Use a 5/32" Allen wrench to completely loosen the upper barrel retainer screw. (See Figure 14.)
2. Use the same size Allen wrench to remove the two barrel retainer screws from the barrel v-block. (See Figure 15.)
3. Remove the barrel v-block and then remove the barrel. (See Figure 16.)



Figure 14

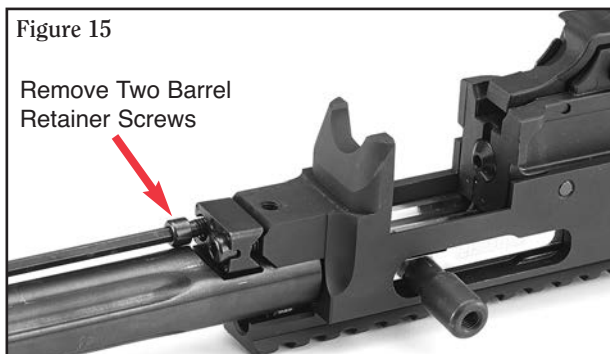

Figure 15

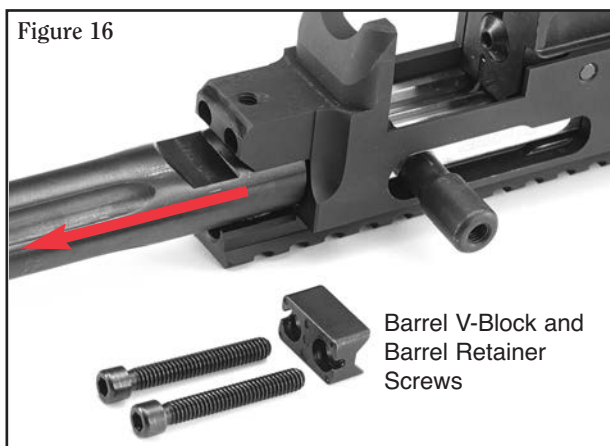

Figure 16

To thoroughly clean the inside of the receiver, remove the bedding block (see instructions on p.10) and remove the bolt. Be aware that although removing and installing the bolt (along with the bolt handle-recoil spring assembly) is simple, it must be done correctly.

#### To Remove the Bolt:

1. Place the safety in the "ON" position. Position the rifle upside down so the bolt is fully accessible.
2. Remove the trigger housing by simply drifting out the two receiver cross pins and lifting the housing up and out of the receiver. (See Figure 11, p. 9.)
3. Drift out the bolt stop pin located at the rear of the receiver. (See Figure 17.)



4. Insert the hex wrench in the bolt handle for leverage and pull the bolt handle fully to the rear of the receiver with your left hand. (See Figures 18A & 18B.)

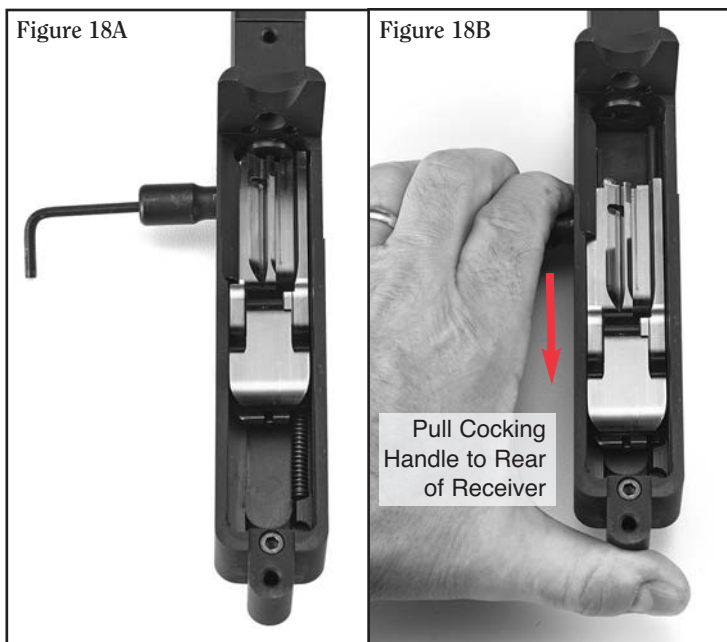

5. While holding the bolt handle in the rearmost position, use your right hand to lift up the front of the bolt until it is disengaged from the bolt handle, and then remove it from the receiver. (See Figure 19.)
6. Keep pressure on the bolt handle as you position the guide rod outside of the ejection port. (See Figure 20.)
7. Slowly remove the bolt handle from the guide rod. Keep pressure on the guide rod spring as you remove the bolt handle so it does not fly away. Remove the guide rod from the "pocket" in the receiver. (See Figure 21.)



Figure 19

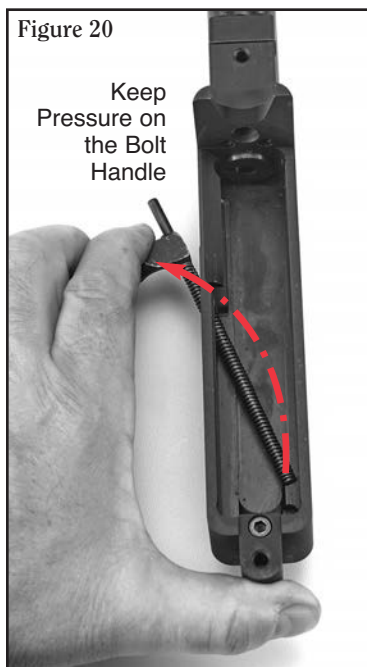

Figure 21

# REASSEMBLY

**AGAIN, BE SURE RIFLE IS UNLOADED!**

## Reassembly of the Bolt Into the Receiver:

1. Place the receiver bottom up on a clean, flat surface. Insert the bolt handle, guide rod, and recoil spring assembly through the ejection port into the “pocket” in the receiver as shown in Figure 22. Keep pressure on the guide rod spring as you do this so it does not fly away. **NOTE:** The bolt handle assembly must be flat against the side and “bottom” of the receiver. (See Figure 23.)
2. Compress and hold the bolt handle assembly to the rear of the receiver. Maintain the assembly in its proper position by keeping pressure on the bolt handle. (See Figure 23.)

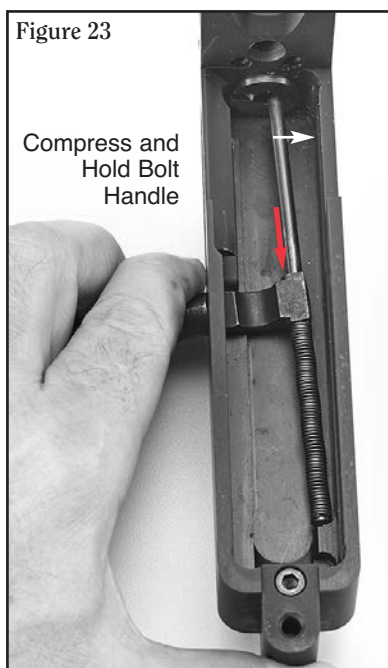
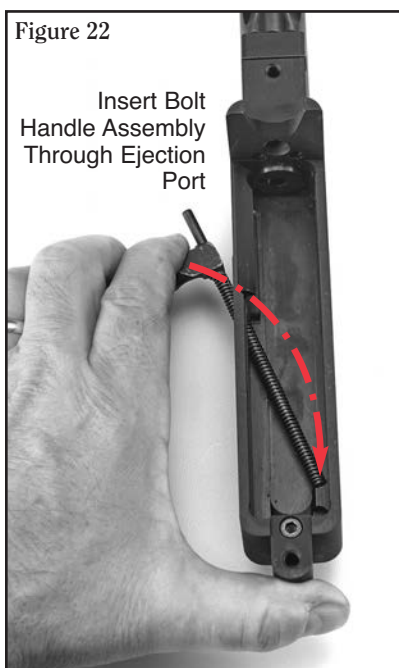

3. While holding the bolt handle assembly back, lay the bolt into the receiver and push it to the rear. Lay the bolt over the bolt handle. (See Figure 24.) Now you can release pressure on the bolt handle assembly and allow the bolt handle to slide the bolt forward. (See Figure 25.)

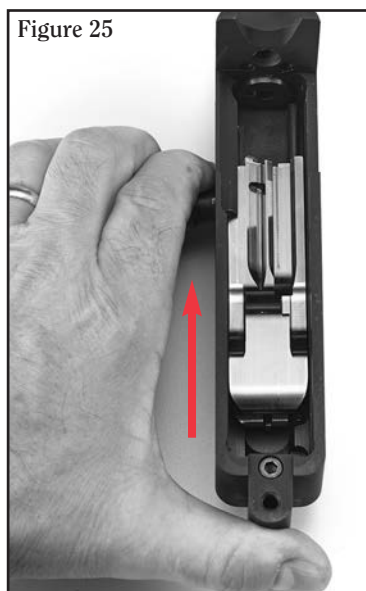

4. Install the bolt stop pin into the rear of the receiver. (See Figure 26.)

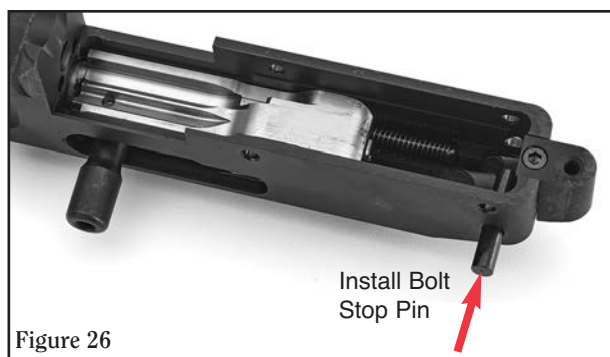

**NOTE:** Cycle the bolt handle a few times to be certain the components are correctly assembled.

**To Reinstall the Barrel (See Figure 27.):**

1. Place the upper barrel retainer screw into the “pocket” in the top of the barrel.
2. Insert the barrel with the screw into the receiver.
3. Hand tighten the upper barrel retainer screw to secure barrel in the receiver.
4. Place the v-block into the notch in the bottom of the barrel.
5. Insert the two lower barrel retainer screws through the holes in the v-block and into the receiver, then hand tighten them until they are securely in place.

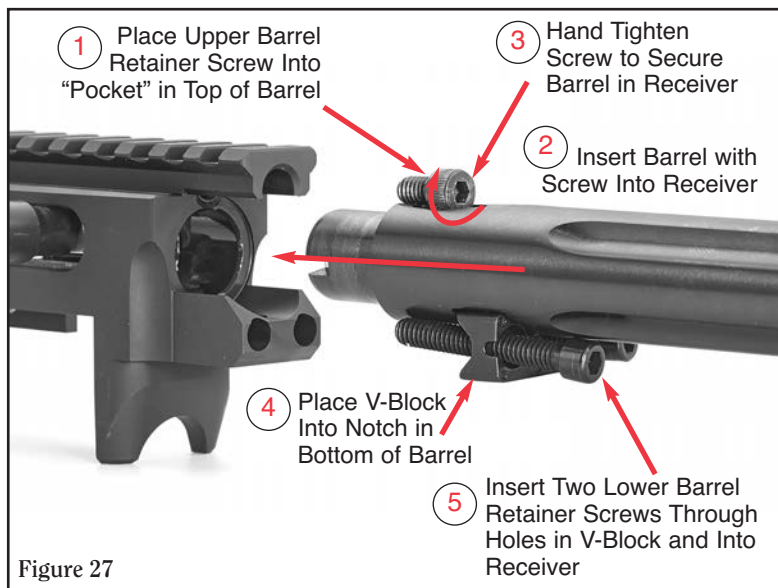



### To Reinstall Trigger Guard Assembly:

1. Install the bolt stop pin and then lay the trigger guard assembly in place and install the two receiver pins (see Figures 28A & 28B). **NOTE:** Be sure the ejector is held in the ejector slot as you set the trigger guard assembly in place.

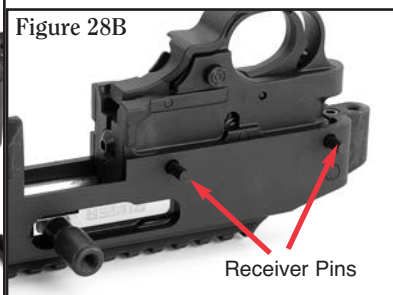
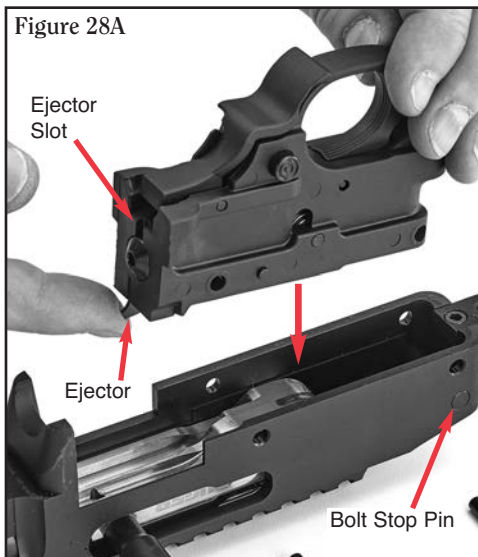

### Barreled-Receiver and Stock Assembly:

1. Be careful the two receiver cross pins and bolt stop pin do not fall out. (See Figure 29.)
2. Position the safety so an equal amount of the button is exposed on each side. (See Figure 30.)

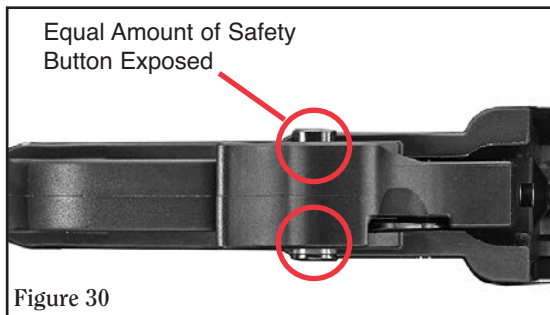

3. Insert the barrel-receiver assembly into the stock. (See Figure 31).

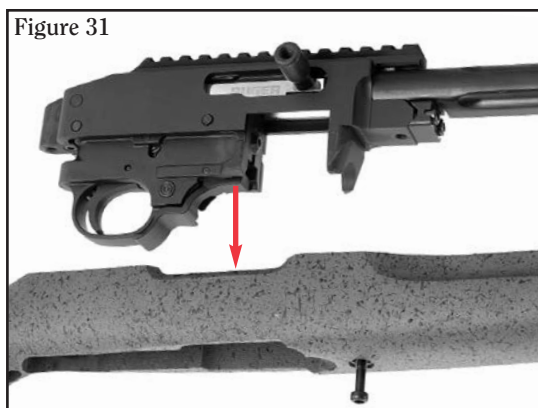

4. Hand tighten the front and rear takedown screws. (See Figure 32).



## Operation Checks:

**Check Operation of Bolt:** Pull the bolt handle back, release, and check the bolt motion forward.

**Check Operation of Safety:** Push the safety button “On” and ensure the trigger does not move.

**Check Operation of Bolt Lock:** Pull the bolt handle back and move the bolt lock into position to hold the bolt back.

**If the rifle does not function properly after installing the barreled-receiver, repeat the steps above or call Ruger Customer Service at 336-949-5200 for further assistance.**

# RUGER® CUSTOM SHOP 10/22® RIFLE

## SUPPLEMENTAL PARTS LIST

(See Additional Parts Lists & Exploded Views on pages 39 - 42 of the Enclosed Instruction Manual)

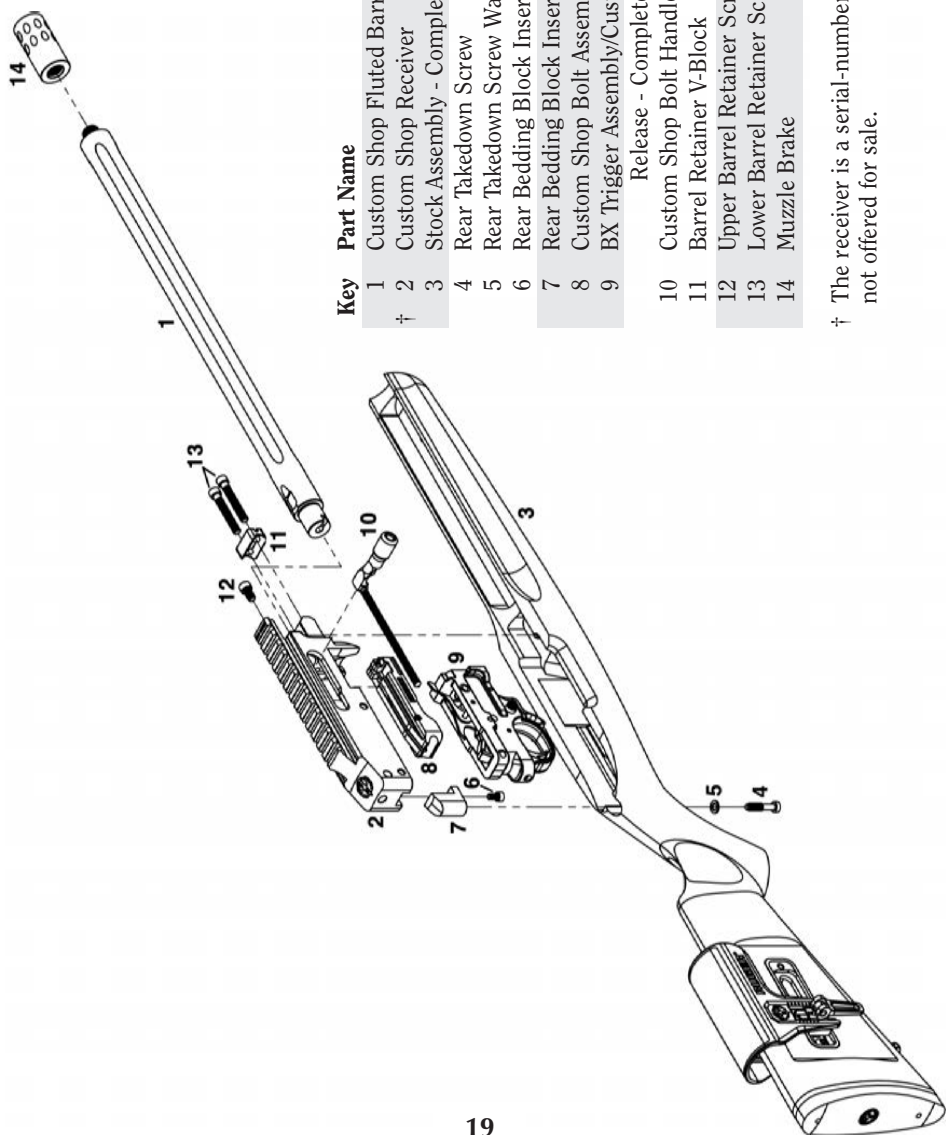

### Key

|     |   |
|-----|---|
| 1   | Custom Shop Fluted Barrel                               |
| † 2 | Custom Shop Receiver                                    |
| 3   | Stock Assembly - Complete                               |
| 4   | Rear Takedown Screw                                     |
| 5   | Rear Takedown Screw Washer, 2 Req'd                     |
| 6   | Rear Bedding Block Insert Screw                         |
| 7   | Rear Bedding Block Insert                               |
| 8   | Custom Shop Bolt Assembly - Complete                    |
| 9   | BX Trigger Assembly/Custom Shop Bolt Release - Complete |
| 10  | Custom Shop Bolt Handle Assembly                        |
| 11  | Barrel Retainer V-Block                                 |
| 12  | Upper Barrel Retainer Screw                             |
| 13  | Lower Barrel Retainer Screw, 2 Req'd                    |
| 14  | Muzzle Brake  |

† The receiver is a serial-numbered part and is not offered for sale.



**STURM, RUGER & COMPANY, INC.**  
**411 SUNAPEE STREET**  
**NEWPORT, NEW HAMPSHIRE 03773 U.S.A.**  
**RUGER.COM**

**ARMS MAKERS FOR RESPONSIBLE CITIZENS®**

**A COPY OF THE INSTRUCTION MANUAL FOR ANY RUGER®  
FIREARM IS AVAILABLE FROM THE FACTORY FREE ON REQUEST, OR IT MAY BE  
DOWNLOADED FROM OUR WEBSITE AT RUGER.COM.  
THESE INSTRUCTION MANUALS CONTAIN IMPORTANT  
WARNINGS WHICH MUST BE UNDERSTOOD  
BEFORE USING THESE FIREARMS.**